

Bushnell®

**UPDATE LASER RANGEFINDER
TO BE LINK ENABLED**

GOLF

LINK  **ENABLED**

GET LINKED!

LINK-Enabled Technology combines your Foresight Sports launch monitor data with the innovation and precision of a Bushnell Golf laser rangefinder, delivering unparalleled course management insight based on your actual ball flight profile and current course conditions. By completing a MyBag Assessment you are then able to LINK your Launch Monitor Data to your Laser Range Finder, providing your custom club recommendations!

COMPATIBLE RANGEFINDERS INCLUDE:

- ProX3
- ProX3+
- ProX3Link
- ProX3+Link



ALREADY OWN A COMPATIBLE LASER RANGEFINDER?

If you already own a LINK-Enabled Laser Rangefinder, see the instructions below to update your Bushnell Golf App & Device Firmware:

1

OPEN APP

UPDATE Or **DOWNLOAD** The Most Recent Version Of The Bushnell Golf App:



Scan the QR code to download the Bushnell Golf Mobile App and register your ProX3 Link Laser Rangefinder.



2 ACCOUNT

Create A User Account Or Sign Into Your Existing Account,
Once Signed In You Will Be Allowed Access To The App:

Sign In



☒ Keep me logged in [Forgot Password?](#)

Sign In



3 SELECT DEVICE

From The Home Screen select My Device & Add Device:

Already Paired

My Devices

See All >

New Device

Add Device

IF YOU HAVE ALREADY SIGNED INTO YOUR ACCOUNT AND PAIRED YOUR DEVICE SKIP TO STEP 7.

4 ADD NEW DEVICE

Select The Laser Rangefinder Model You Wish To Pair:



Compatible Link Enabled Devices Include:

- ProX3
- ProX3+
- ProX3Link
- ProX3+Link

5 SELECT DEVICE

Select The Device & Follow On Screen Prompts To Begin Pairing Process

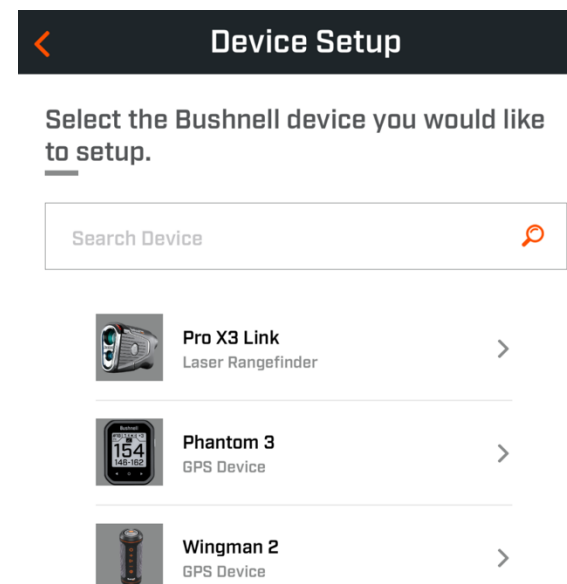

6 PAIR LASER RANGEFINDER

Identify The MODE & POWER Button On The Top Of The Laser Rangefinder:



Hold Down Mode Button On Laser Rangefinder Until The Scope Presents The MODE SETTINGS

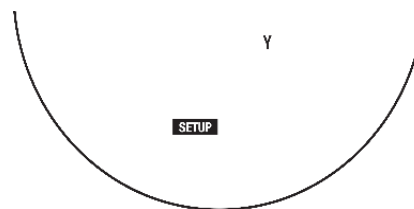

Then Press and Release Power Button To Cycle To Bluetooth Settings

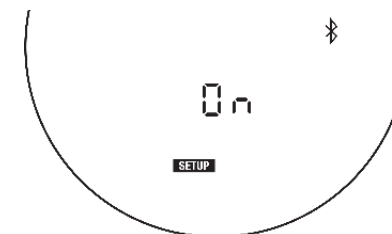

Press The Mode Button Until You See PAIR on the Scope



Then Press and Release The Power Button Once To Have The Scope Present A Bluetooth Pairing Code



Enter The Pairing Code To The App When Requested

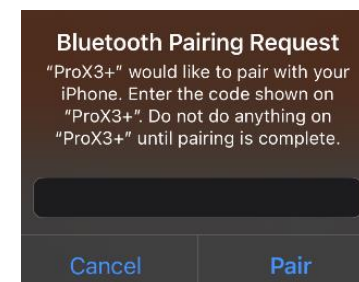

**** If Bluetooth Pairing Fails, Repeat Pairing Steps Until Paired Successfully.**

7 SELECT DEVICE

Once Paired. Select The Device From The My Devices List.

My Devices

[See All >](#)

Pro X3+

SN#: BB403031135

 **Connected**



Phantom 3

SN#: PL408005522

 **Disconnected**

8 OPEN UPDATE

Select **DEVICE UPDATE** button from Device Options.



Device Update

9

RUN UPDATE

Select **UPDATE** & Follow On Screen Instructions To Update Device Firmware.

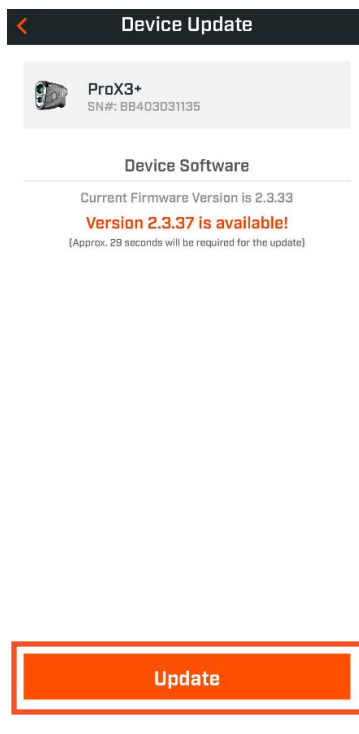

10

MYBAG

Once the update is completed you will see a **MyBag** Icon. Select The **MyBag Icon** to proceed, or to learn more about the MyBag Assessment, please see the [MyBag Guide](#).

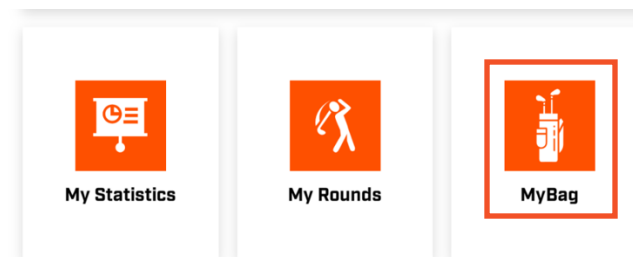

FOR CUSTOMER SUPPORT VISIT:
WWW.BUSHNELLGOLF.COM/SUPPORT